

FLEX STRIP Eco Basic and Pro IP65



Features and Benefits



Flex Strip IP65 uses multiple-chip LED technology to create a superior linear strip light source. Flex Strip produces a very high light output, and it's also very efficient, compared with conventional LED strip lighting. Meanwhile it maintains the excellent and uniform effects thanks to the intelligent electrical design and LED wide angle. Flex Strip IP65 gives you freedom of design when you work on your light project. It's slim, completely flexible, waterproof, ultra-bright and very easy to install.

Technical Parameters

High illumination output value

The light is strong but without hot spots or uneven spots. No "light dots"

Long operating life: 50,000 hrs

Complete system: Fixing brackets, cable, end-caps are provided

IP65 for outdoor use

Impressive flexibility and low weight

Resistant to vibration

Wide operating temperature: It can be operated between -40° to +60°C. A more extreme temperature may destroy the components or resin

Don't expose it to salty water

Technical Performance

CODE	REFERENCE	COLOR TEMPERATURE	LED QTY/mtr	POWER W/mtr	LENGTH	LIGHT OUTPUT (lm/mtr)	CUTTING UNIT	BEAM ANGLE (°)	VOLTAGE (V DC)	CONTINUOUS CONNECTION (m)
20190038	FLEX STRIP ECO IP 65 SILICON	3000K	60	4.8	5m	162	50mm	120	12	12
20190039	FLEX STRIP ECO IP 65 SILICON	6000K	60	4.8	5m	210	50mm	120	12	12
20190040	FLEX STRIP ECO IP 65 EPOXY	3000K	60	4.8	5m	162	50mm	120	12	12
20190041	FLEX STRIP ECO IP 65 EPOXY	6000K	60	4.8	5m	210	50mm	120	12	12
20190046	FLEX STRIP BASIC IP 65 SILICON	3000K	78	15.6	5m	390	38mm	120	12	12
20190047	FLEX STRIP BASIC IP 65 SILICON	6000K	78	15.6	5m	490	38mm	120	12	12

Applications

Cove light, ceiling light

Architectural lights for canopy, corridor, window, archway

Backlight or edge lighting for signage

DIY lights for home use

Path and contour marking

Decorative lights for holiday, event, show, exhibition

Other outdoor uses

Warranty

3 years

CODE	REFERENCE	COLOR TEMPERATURE	LED QTY/mtr	POWER W/mtr	LENGTH	LIGHT OUTPUT (lm/mtr)	CUTTING UNIT	BEAM ANGLE (°)	VOLTAGE (V DC)	CONTINUOUS CONNECTION (m)
20190042	FLEX STRIP PRO IP 65 SILICON	3000K	120	19.2	5m	750	25mm	120	12	12
20190043	FLEX STRIP PRO IP 65 SILICON	6000K	120	19.2	5m	970	25mm	120	12	12
20190044	FLEX STRIP PRO IP 65 EPOXY	3000K	120	19.2	5m	750	25mm	120	12	12
20190045	FLEX STRIP PRO IP 65 EPOXY	6000K	120	19.2	5m	970	25mm	120	12	12

Dimensions

Flex strip ECO

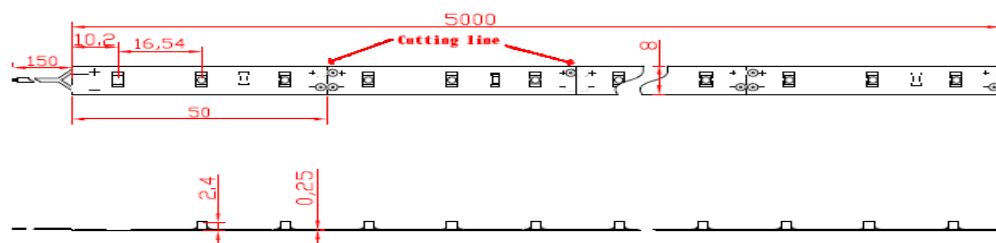

Flex strip BASIC

Drawings need to be changed. Add + 3mm on width

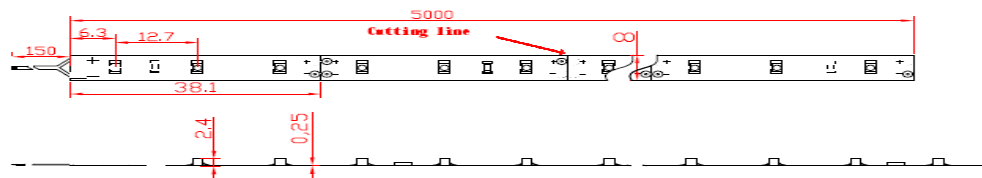

Flex strip PRO

Drawings need to be changed. Add + 3mm on width

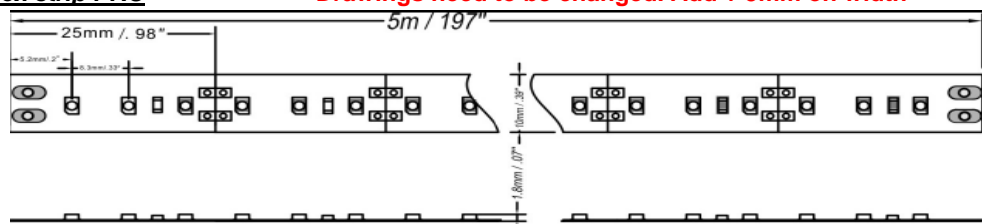

Packaging

5m/reel



100 reels/carton

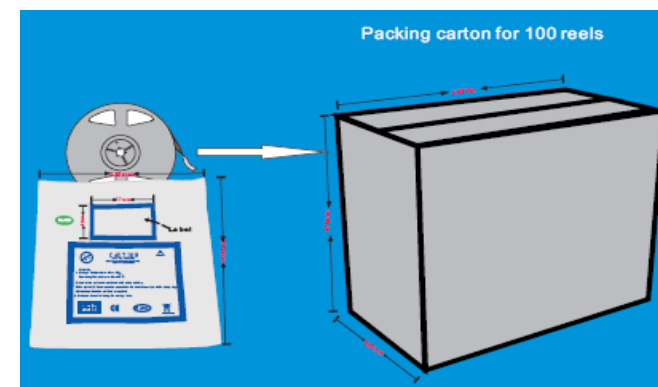

Assembly

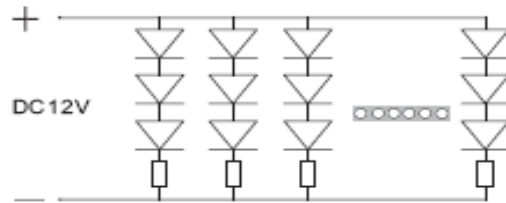

1. Solder connection should only be performed on designated solder pads(marked +/-). During soldering, don't exceed the maximum soldering time of 10 seconds and the maximum soldering temperature of 260 Celsius degrees.
2. The smallest unit(25mm/1"-6 LEDs)can be removed by cutting with scissors between the designated solder pads.
3. The mounting of the strip is facilitated by means of the double-sided adhesive on the back-surface of the strip. Care must be taken to provide a clean and dry mounting surface, free of oils or silicone coatings as well as dirt particle. The mounting substrate must have sufficient structural integrity. Take care to completely remove the adhesive backing. Once the strip is appropriately positioned. Press on the strip with about 20N/cm2(refer to application techniques of 3M adhesive transfer tapes).
4. The minimum bending radius is 2cm. The strip may be bent over a smaller radius of the circuit board containing no electronic components and such bends should be made once and fixed in position to avoid cyclic fatigue.
5. Adequate and proper power supply should be applied to run IRIS flex strip
6. Power supply with voltage DC 15V is not allowed to use. User can calculate the power consumption according to the electrical data, then decide what power supply should be applied.
7. 5 meters are recommended as the reasonable connection length of the flex strip If more length connected, the brightness will be quite lower.
8. Controller is necessary to dim or create an animation for fixed color and RGB version.

Accessories



Iris equips 5 free connectors(wire to ribbon and ribbon to ribbon) in every packing bag. The connectors are necessary for cutting the strip

Safety Information

1. The strip itself and all its components may not be mechanically stressed.
2. Assembly must not damage or destroy conducting paths on the circuit board.
3. Electrical and safety standards. Only qualified personnel should be allowed to perform installations.
4. Correct electrical polarity needs to be observed. Wrong polarity may destroy the strip.
5. Parallel connection is highly recommended as safe electrical operation mode.
6. Serial connection is not recommended. Unbalanced voltage drop can cause hazardous overload and damage the strip.
7. Please ensure that the power supply is of adapters power to operate the total load. The adaptor power supply should be able to load 8A to run 5 meters.
8. When mounting on metallic or otherwise conductive surfaces, there needs to be an electrical isolation points between strip and the mounting surface.
9. Pay attention to standard ESD precautions when installing the strip.
10. Damaged by corrosion will not be honored as a materials defect claim. It is use's responsibility to provide suitable protection against corrosive agents such as moisture and condensation and other harmful elements.
11. After cutting along the line, if you want to connect the cutting sections or connect one section to power, the connectors will be necessary.